

Product for aftermarket applications

AIR CONDITIONING COMPRESSOR BEARINGS

RODAMIENTOS DE COMPRESOR

DE AIRE ACONDICIONADO

ROULEMENT DE COMPRESSEUR

DE CLIMATISATION

LAGER FÜR KLIMAKOMPRESSOREN

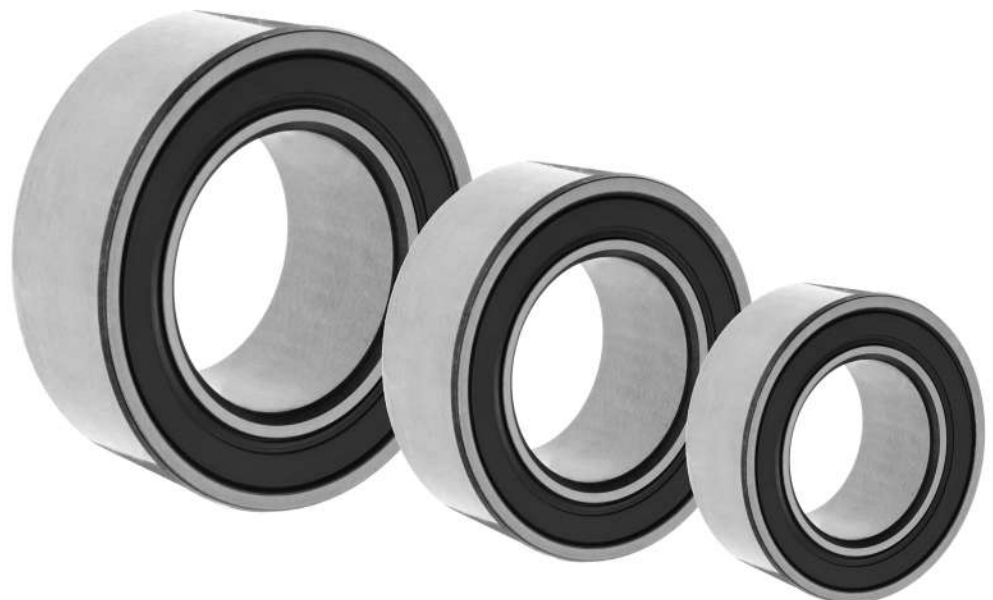

⚠ WARNING Failure to observe the following warnings could create a risk of serious injury.

Proper maintenance and handling procedures are critical. Always follow installation instructions and maintain proper lubrication.

Never spin a bearing with compressed air. The rollers may be forcefully expelled.

Note

IRB has taken extreme care in the research and production of this catalog, but cannot under any circumstances be liable for any errors or omissions. IRB reserves the right to modify the contents of this catalog without prior notice. The contents of this catalog are the property of IRB and may not be reproduced, in any form, in whole or in part, without written permission from IRB. Application data may only apply up to the catalog publication date shown on the cover.

⚠ ¡ADVERTENCIA! El incumplimiento de las siguientes normas de seguridad puede originar daños físicos a personas.

Es de vital importancia llevar a cabo unas prácticas adecuadas de mantenimiento y manipulación. No cumplir con las instrucciones de montaje dictadas por el fabricante del vehículo ni realizar una lubricación adecuada de mantenimiento podría provocar fallos en el equipo.

No haga girar nunca un rodamiento con aire comprimido. Los rodillos podrían salir proyectados.

Nota

IRB ha dedicado especial cuidado a la realización de las labores de documentación y elaboración de este catálogo, pero declina cualquier tipo de responsabilidad por errores u omisiones en los que pueda haberse incurrido en la edición del mismo. IRB se reserva el derecho de modificar el contenido de este catálogo sin notificación previa. Este catálogo es propiedad de IRB, no estando autorizada su reproducción, en ningún modo, parcial ni total, si no se cuenta con el permiso escrito de IRB. La información de aplicaciones de productos puede ser válida únicamente hasta la fecha de publicación de este catálogo mostrada en la portada del mismo.

⚠ AVERTISSEMENT! Le non-respect des consignes ci-dessous peut engendrer un risque sérieux de dommages corporels.

Le respect des consignes de montage et de maintenance est essentiel. Le non-respect des instructions de montage fournies par le fabricant du véhicule et une lubrification inappropriée peuvent entraîner un dysfonctionnement de l'appareil.

Ne jamais actionner un roulement avec de l'air comprimé. Les rouleaux peuvent être éjectés violemment.

Note

IRB a apporté toute son attention à l'élaboration et à la production de ce catalogue mais ne peut être tenue pour responsable en cas d'erreur ou d'omission. IRB se réserve le droit de modifier le contenu de ce catalogue sans avertissement préalable. Le contenu de ce catalogue est la propriété de IRB et ne peut être reproduit sous quelque forme que ce soit, dans son intégralité ou partiellement, sans autorisation écrite de IRB. Les informations des différentes applications ne s'appliquent qu'à la date de publication figurant sur la couverture du catalogue.

⚠ ACHTUNG! Missachtung der folgenden Warnhinweise kann schwere körperliche Verletzungen verursachen.

Wartung und Einsatz der Produkte müssen fachgerecht erfolgen. Die Missachtung der Einbauvorschriften des Fahrzeugherstellers und unsachgemäße Schmierung können zu einem Ausfall der Anwendung führen.

Drehen Sie Wälzlager nie mit Druckluft. Die Wälzkörper könnten dabei herausgeschleudert werden.

Anmerkung

Dieser Katalog wurde von IRB mit größter Sorgfalt hergestellt. Die Haftung für etwaige Fehler oder Weglassungen ist ausgeschlossen. IRB behält sich das Recht vor, den Inhalt dieser Druckschrift ohne vorherige Ankündigung zu modifizieren. Der Inhalt dieser Druckschrift ist geistiges Eigentum der IRB. Er darf ohne schriftliche Genehmigung in keiner Form, weder als Ganzes noch in Auszügen, reproduziert werden.

⚠ ATTENZIONE! La non osservanza delle seguenti raccomandazioni può creare seri rischi di danni fisici.

L'adozione di procedure corrette di manutenzione e manipolazione è di importanza fondamentale. Il mancato rispetto delle istruzioni di installazione del costruttore del veicolo e una lubrificazione scorretta possono danneggiare l'attrezzatura.

Non utilizzare mai aria compressa per far ruotare un cuscinetto. La forza dell'aria compressa può causare l'espulsione ad alta velocità dei rulli.

Nota

Il presente catalogo è stato redatto a cura di IRB la quale, in nessuna circostanza, potrà essere ritenuta responsabile per eventuali errori o/è omissioni in esso riscontrabili. IRB si riserva il diritto di modificare il contenuto del presente catalogo senza preavviso. Il contenuto di questo documento è di proprietà di IRB e non può essere riprodotto - integralmente o in parte - in nessuna forma senza autorizzazione scritta da parte di IRB. I dati delle applicazioni valgono soltanto fino alla data riportata sulla copertina.

⚠ AVISO! A não observação dos seguintes avisos poderá resultar num risco de danos pessoais graves.

A manutenção e o manuseio apropriados são muito importantes. A não observação das instruções de instalação do fabricante do veículo e a lubrificação inapropriada podem levar a uma avaria do equipamento.

Nunca gire os rolamentos com ar comprimido. Os roletes podem ser projectados a alta velocidade.

Note

A IRB dedicou um especial cuidado à pesquisa e elaboração deste catálogo, mas não pode assumir, em qualquer circunstância, responsabilidade por eventuais erros ou omissões. A IRB reserva-se o direito de alterar o conteúdo deste catálogo sem aviso prévio. Todo o conteúdo deste catálogo é propriedade de IRB e não pode ser reproduzido, em qualquer meio ou forma, no todo ou em parte, sem a permissão escrita de IRB. Os dados relativos às aplicações poderão aplicar-se apenas até à data de publicação do catálogo indicada na capa.

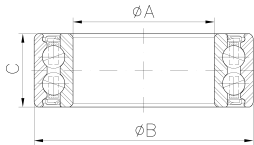

A	B	C	IRB reference	Application 	Cross references
30	45	18	8910	Hyundai passenger cars	NACHI 30BG04S22G-2DL, NSK 30BD4518T12DDUKCG21
30	47	12	8911		NACHI 30BX04S1DST
30	47	18	8912	Sanden and Denso compressors	NACHI 30BGS04S8G-2DS, NACHI 30BG04S16G-2DSTF, NSK 30BD4718DDUKK, KOYO 83A693
30	47	21/18	8913	Isuzu	KOYO 83A693ACS20
30	52	20	8914		NACHI 30BG32G-2DST
30	52	22	8902	NipponDenso10PA15-10PA17-10PA20 Denso compressors Toyota Hilux 98-02, Honda, Mitsubishi, Mazda, Chrysler, BMW, Mercedes-Benz, Porsche, Jaguar, Rover, Fiat, GM, Kia, John Deere	NACHI 30BG05S2G-2DS, NACHI 30BG5222-2DSE, NACHI 30BGS10G-2DST2F, KOYO DAC3052-32RR9XS, NIPPONDENSO 949100-4570 NIPPONDENSO 949100-4760, TOYOTA 51802600
30	55	23	8906	NipponDenso10PA17C-10PA20C, Ford FX15-FS10 Behr, Bosch, Diesel Kiki, Nihon, York compressors (Ford, Hyundai and Kia).	NACHI 30BG05S5G-2DS, NACHI 5006-2NSL, NSK 30BD40AT12DDUCG21SBU2ENRL, OE 51441200, OE 51655700, OE 51651700, OE 50178800, OE 50184000, OE 51655700
30	62	26,99	8915	Chrysler and White compressors	NACHI 30BGS1G-2DSKAI, NACHI 30BGS1G-2NSL, KOYO BD30-11A
32	47	18	8916	Ogura compressors, vacuum pumps for Akti industrial trucks, and Matsushita compressors for Suzuki passenger cars.	NACHI 32BG04S3G-2DL, NSK 32BD4718DU
32	52	20/18	8917	Seiko-Seiki air conditioning compressors BMW 3 series, and Mercedes Benz smog pumps	
32	55	13	8931		
32	55	23	8918	Matsushita, Panasonic, <seiko Seiki, York compressors Mazda vehicles	NACHI 32BG05S1-2DST, NSK 32BD4ST12DDUCG21, OE 51550900, OE 50295200, OE 51501200, OE 51749900

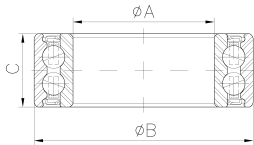

A	B	C	IRB reference	Application 	Cross references
35	50	20	8919	Delphi, Mitsubishi, Sanden, Seiko Seiki compressors Mitsubishi and Mazda vehicles.	NACHI 35BG05S7G-2DST, NACHI 35BG05S7G-2DL, NSK 35BD5020DDUCG21, KOYO DAC35500020, NTN SNR ACB35X50X20, FCK 30BF5020, OE 51555200, OE 51771400
35	52	12	8920	Denso compressors 6SEU12C (Fiat Stilo, Mercedes Benz Class A, Toyota Yaris)	NACHI BX5212S1-2DST2B1
35	52	20	8921		NACHI 35BG5220-2DL, NSK 35BD5220DF, NTN SNR ACB35X52X20
35	52	22	8903	Delphi and Denso compressors. Denso 6CA17, 7SB16C	NACHI 35BG05S6G-2DST2F NACHI 35BG5222-2DL, KOYO DAC35520022, NSK 35BD5222DDUM18A, NTN SNR ACB35X52X22
35	55	20	8901	Sanden SD505, 507, 708, 709, 7V16, 5H13, 5H14, 7H13, 7h15, Diesel Kiki DSK15BH-DSK15CH ; Nihon DKV14C-DKV14D ; Seltec CH-TM Diesel Kiki, Matsushita, Nihon, Sanden, Seltec compressors on Kia, Hyundai, GM and Chrysler vehicles	NACHI 35BG05G-2DS, NACHI 35BG05S10G-2DST2, NACHI 35BG05S16G-2DL, NACHI 35BGS5S10G-2DST2, NSK 35BD219T12DDUCG21ENSL, NSK 35BD219T12DDUK8CG21EAIL, NTN SNR ACB35X55X20, KOYO 83A694, KOYO DAC3555RD3H, OE 51651600, OE 51793800, OE 50985400, OE 51427500, OE 51323500, OE 51799900, OE 51216600
35	62	21	8922		NACHI 35BG06G-2DS, NIPPONDENSO 949100-2720
35	62	24	8904	Zexel DCW	NSK 35BD6224AT12, NSK 35BD6224DDUK, NSK 35BD6224DV, FCK 35BD6224, NTN SNR ACB35X62X24
38	54	17	8923	Denso compressors Suzuki, VW and Diat vehicles	NACHI 38BG05S2G-2DS, NACHI 38BG05S6G-2DST2F, NACHI 38BG05S6G-2DST2FB, NIPPONDENSO 949100-4810
40	55	24	8924	Mitsubishi compressors	NACHI 40BGS40G-2DST

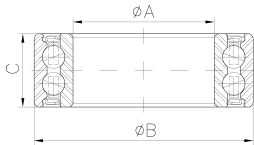

A	B	C	IRB reference	Application 	Cross references
40	57	24	8925	Mitsubishi and Sanden compressors	NACHI 40BG05S2G-2DS, NSK 40BD4ST12DDUCG21ENSL
40	62	20,6	8900	Delphi V5, Harrison A6 - R4, Keihin 150 L- 150R Seiko Seiki compressors on GM, Daewoo vehicles Keihin,	NACHI 40BG62020-2DLCS, NACHI 40BGS8G-2DS, NSK 40BD49T12DDUCG33, NSK 40BD49T12DDU28DCA-3AENSK7, NTN 2TS2DF0893LLACS01, KOYO 83A5519, GM 6557684, 6559469, DAEWOO 712019-NBR-2CS
40	62	24/20,6	8926	Denso compressors Ford, Hino, Mazda vehicles	NACHI 40BGS12G-2DS, NACHI 40BGS36G-2DST2F, NSK 40BD49AWT12DDU5CS75PAISRIL, NIPPONDENSO 949100-4610, 949100-4860
40	62	24	8905	Denso, Hitachi, Nihon, Sanden, Seiko Seiki compressors on Toyota, Daihatsu, Mitsubishi, Rover, VW, Fiat, John Deere vehicles. Sanden SD507, 508, 510, 708, 709, 5H13, 5H14, Diesel Kiki DKS, Hitachi MJS170;Nihon DKV14C, NipponDenso 10P13C-10P15C-10P17C; Ogura 6"	NACHI 40BG11G-2DS, NACHI 40BGS11G-2NSL, NACHI 40BGS35G-2DL, NACHI 40BGS35G-2DST, NACHI 40BGS35G-2DSTF, NACHI 40BGS11G-2DS, NSK 40BD219T12DDUCG21ENSL, NSK 40BD219DU, NTN 2TS2DP0865LLBS45/SC, KOYO 83A551B4CS2, NIPPONDENSO 949100-4850, NIPPONDENSO 949100-2710, NTN SNR ACB40X62X24
40	66	24	8927	Mitsubishi compressors	NACHI 40BG39G-2DL, NACHI 40BGS39G-2DST
40	68	30	8928		NSK 40BD6830DUK
45	75	32	8929	Fuso vehicles	NACHI 45BG07S5G-2DST2F, NIPPONDENSO 949100-4800
50	72	20	8930		NACHI 50BG07S1



Product for aftermarket applications

WHEEL BEARINGS & KITS
TENSIONERS & TIMING BELT KITS
CLUTCH RELEASE BEARINGS
STEERING BEARINGS
SWIVEL PIN BEARINGS
CYLINDRICAL ROLLER BEARINGS
NEEDLE ROLLER BEARINGS
AIR CONDITIONING COMPRESSOR BEARINGS
SUSPENSION ARM KITS
DEEP GROOVE BALL BEARINGS
BALL JOINTS

Quality, Service & Technology

IRB Bearings
Rodamientos IRB Bilbao
Doctor Díaz Emparanza, 3
48002 Bilbao (Spain)
Tel. +34 94 443 14 00
Fax +34 94 444 09 05
E-mail: irb@irb-bearings.com
www.irb-bearings.com



2018
Printed in Europe